

# FOR LEASE

14,880 Total SF  
\$0.61/SF Gross



14950 Heathrow Forest Parkway, Suite 100  
Houston, TX 77032 Phone: 281-442-5404



## TRANSCENTRAL BUSINESS PARK

16560 AIR CENTER BLVD HOUSTON, TX 77032

### DETAILS

- Attractive flex-industrial park in Central Green area of North Houston, near IAH airport
- Easy access to I-45, Beltway 8 & Hardy Toll Rd.
- Private security patrolled
- Truck doors: Dock-high (4), semi dock (3), & grade-level ramps (3)
- Large (±30K SF) fenced-in outside storage
- Space dimensions and amenities:
  - 12,880 SF Warehouse
  - 2,000 SF Office
  - Triple-wide ramp
  - 1 oversized ramp door (13H x 12W)

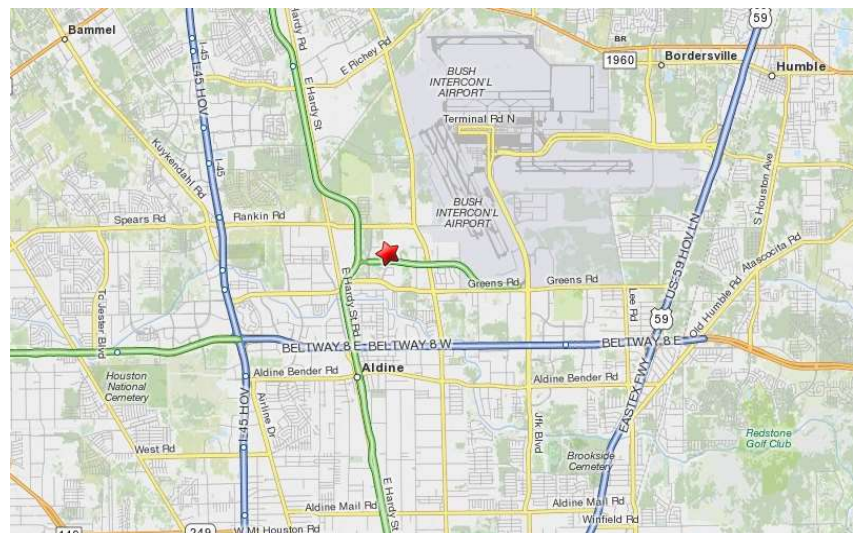

© 2019 Brummett and Company. The information above is believed reliable. While its accuracy is not doubted, no guarantee, warranty or representation about it is hereby stated or implied. It is the responsibility of any interested party to independently confirm its accuracy and completeness. Rates quoted are "as-is" initial base rents only. Interested parties should conduct a careful, independent investigation of the properties to determine suitability.

# FOR LEASE

14,880 Total SF  
\$0.61/SF Gross



14950 Heathrow Forest Parkway, Suite 100  
Houston, TX 77032 Phone: 281-442-5404

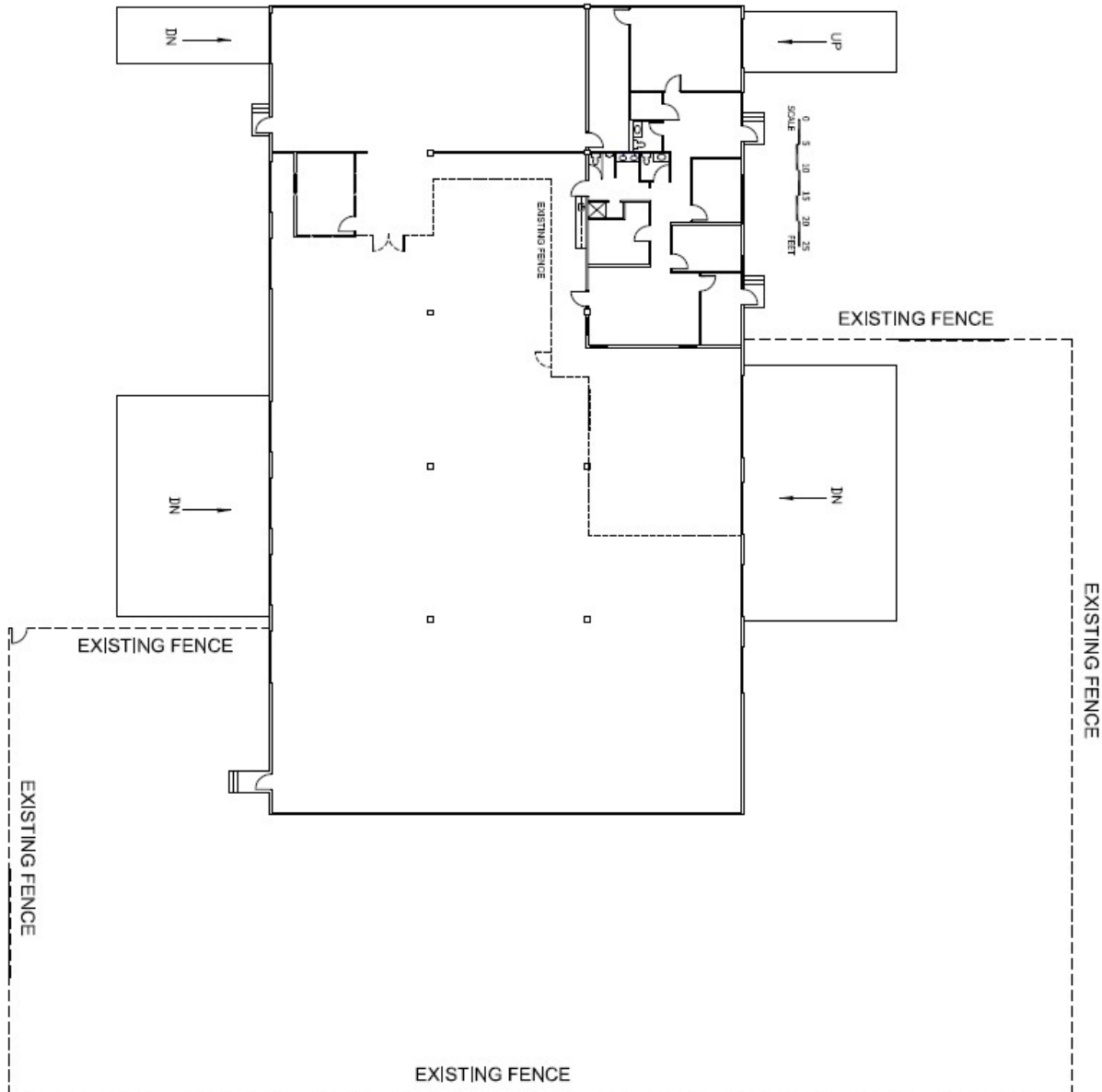

## TRANSCENTRAL BUSINESS PARK

16560 AIR CENTER BLVD HOUSTON, TX 77032

© 2019 Brummett and Company. The information above is believed reliable. While its accuracy is not doubted, no guarantee, warranty or representation about it is hereby stated or implied. It is the responsibility of any interested party to independently confirm its accuracy and completeness. Rates quoted are "as-is" initial base rents only. Interested parties should conduct a careful, independent investigation of the properties to determine suitability.